



TRANSPORTATION CABINET

Frankfort, Kentucky 40622
www.transportation.ky.gov/

Steven L. Beshear
Governor

Michael W. Hancock, P.E.
Secretary

December 9, 2014

CALL NO. 103
CONTRACT ID NO. 144208
ADDENDUM # 3

Subject: Hardin County, HSIP 0311 (030)
Letting December 12, 2014

- (1) Revised - Paving Summary - Page 44 of 113
- (2) Revised - Typical Section - Page 46 of 113
- (3) Revised - Bid Items - Page 113 of 113

Proposal revisions are available at <http://transportation.ky.gov/Construction-Procurement/>.

If you have any questions, please contact us at 502-564-3500.

Sincerely,

A handwritten signature in blue ink that reads "Diana Castle Radcliffe".

Diana Castle Radcliffe
Director
Division of Construction Procurement

DR:ks
Enclosures



An Equal Opportunity Employer M/F/D

PAVING AREAS

ITEM	PAVING AREAS										TOTAL PROJECT		
	SOUTH BOUND LANE	RT TURN LANE	PEAR ORCHARD	CABINET DR	U	A	R	E	Y	A		R	D
1.25" CL3 0.38A PG64-22 SURFACE	2613	311	262										3187
3.75" CL3 1.00D PG64-22 BASE	2634	313	264										3211
3.75" CL3 1.00D PG64-22 BASE	2505	298	247										3051
4.00" CL3 1.00D PG64-22 BASE	2564	305	253										3121
① 4.00" CRUSHED STONE BASE	2626	313	258										3197

PAVING SUMMARY

ITEM CODE	ITEM	UNIT	SOUTH BOUND LANE	RT TURN LANE	PEAR ORCHARD	CABINET DR	TOTAL PROJECT
22906SA03	CL3 0.38A PG64-22 SURFACE	TON	180	21	18		219
00214	CL3 1.00D PG64-22 BASE	TON	1624	193	161		1978
00003	① ② CRUSHED STONE BASE	TON	604	72	59		1235

NOTES

- ALL ASPHALT MIXTURES SHALL BE ESTIMATED AT 110 LBS. PER SQ. YD. PER INCH OF DEPTH, UNLESS NOTED OTHERWISE.
- ① ESTIMATED AT 115 LBS. PER SQ. YD. PER INCH OF DEPTH.
- ② INCLUDES 500 TONS FOR SHOULDERS

SCALE: 1" = NA

COUNTY OF	ITEM NO.	SHEET NO.
HARDIN	4-931	

4-931 PAVING SUMMARY
US31W SAFETY IMPROVEMENT

4-931 TYPICAL SECTIONS

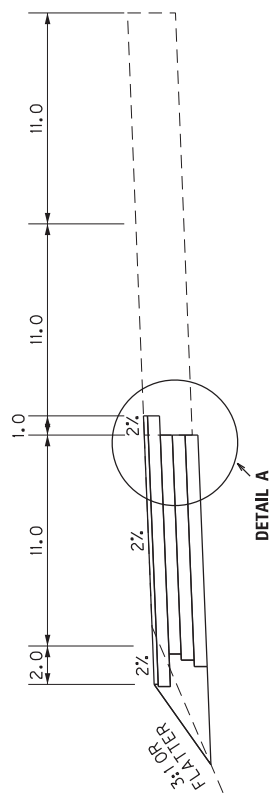

US31W SOUTHBOUND LANE ADDITION
& RIGHT TURN LANE ONTO VETERANS WAY
STA 190+50 TO STA 208+00

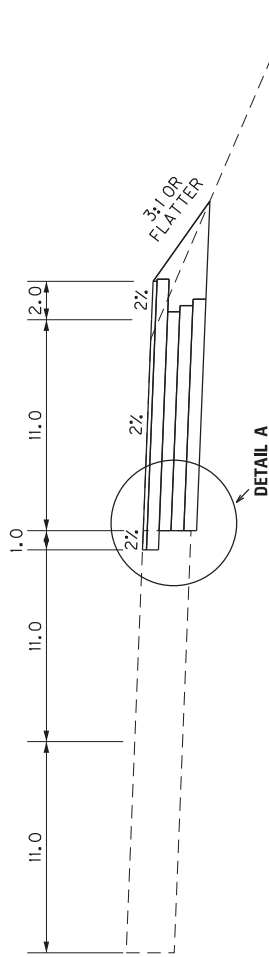

US31W RIGHT TURN PEAR ORCHARD NW
STA 189+00 TO STA 190+50

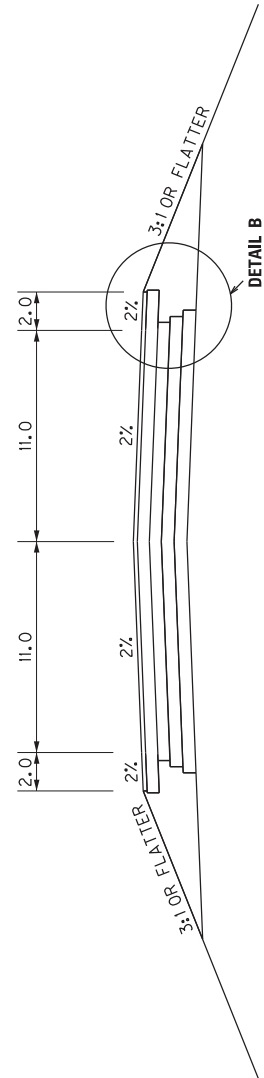

CABINET DR TYPICAL SECTION
REPLACEMENT OF CONCRETE APPROACH

DETAIL A

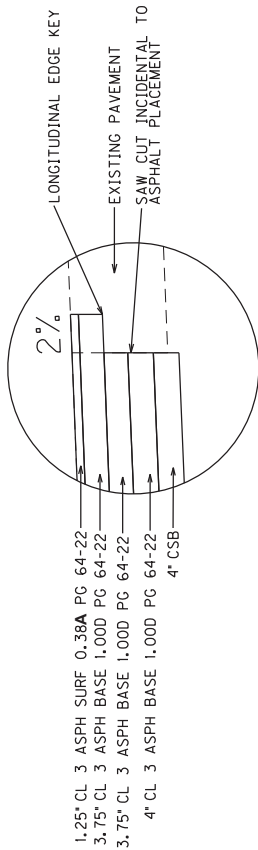

DETAIL B

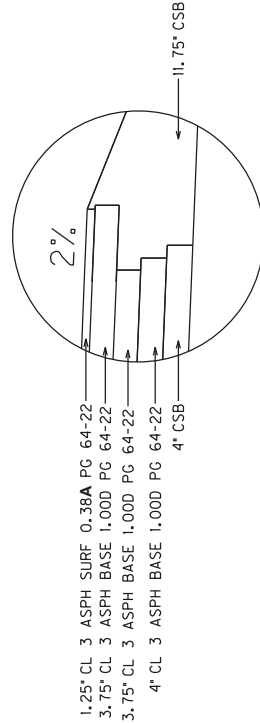

PAVEMENT DESIGN

MAINLINE FULL DEPTH AND WIDENING & CABINET DR
 1.25\"/>

RIGHT TURN LANE INTO VETERANS BLVD
 1.25\"/>

RIGHT TURN LANE INTO SW PEAR ORCHARD RD
 1.25\"/>

SCALE: 1"= NA

COUNTY OF	ITEM NO.	SHEET NO.
HARDIN	4-931	NA

4-931 TYPICAL SECTIONS US31W SAFETY IMPROVEMENT

PROPOSAL BID ITEMS

144208

Page 1 of 1

Report Date 12/9/14

Section: 0001 - ROADWAY

LINE	BID CODE	ALT	DESCRIPTION	QUANTITY	UNIT	UNIT PRIC	FP	AMOUNT
0010	00003		CRUSHED STONE BASE	1,235.00	TON		\$	
0020	00214		CL3 ASPH BASE 1.00D PG64-22	1,978.00	TON		\$	
0030	22906ES403		CL3 ASPH SURF 0.38A PG64-22 (REVISED: 12-9-14)	219.00	TON		\$	
0040	02200		ROADWAY EXCAVATION	1,080.00	CUYD		\$	
0050	02562		TEMPORARY SIGNS	500.00	SQFT		\$	
0060	02650		MAINTAIN & CONTROL TRAFFIC	1.00	LS		\$	
0070	04830		LOOP WIRE	2,120.00	LF		\$	
0080	04844		CABLE-NO. 14/5C	5,000.00	LF		\$	
0090	04850		CABLE-NO. 14/1 PAIR	800.00	LF		\$	
0100	04895		LOOP SAW SLOT AND FILL	710.00	LF		\$	
0110	06514		PAVE STRIPING-PERM PAINT-4 IN	27,580.00	LF		\$	
0120	06546		PAVE STRIPING-THERMO-12 IN W	3,537.00	LF		\$	
0130	06574		PAVE MARKING-THERMO CURV ARROW	76.00	EACH		\$	
0140	06575		PAVE MARKING-THERMO COMB ARROW	5.00	EACH		\$	
0150	06592		PAVEMENT MARKER TYPE V-B W/R	100.00	EACH		\$	
0160	06600		REMOVE PAVEMENT MARKER TYPE V	40.00	EACH		\$	
0170	20188NS835		INSTALL LED SIGNAL-3 SECTION	72.00	EACH		\$	
0180	20266ES835		INSTALL LED SIGNAL- 4 SECTION	35.00	EACH		\$	
0190	21289ED		LONGITUDINAL EDGE KEY	1,800.00	LF		\$	
0200	22664EN		WATER BLASTING EXISTING STRIPE	2,320.00	LF		\$	
0210	23875NC		REMOVE THERMOPLASTIC ARROWS	50.00	EACH		\$	

Section: 0002 - DEMOBILIZATION

LINE	BID CODE	ALT	DESCRIPTION	QUANTITY	UNIT	UNIT PRIC	FP	AMOUNT
0220	02569		DEMOBILIZATION	1.00	LS		\$	